

1016 GREENTREE ROAD

Pittsburgh, PA 15220

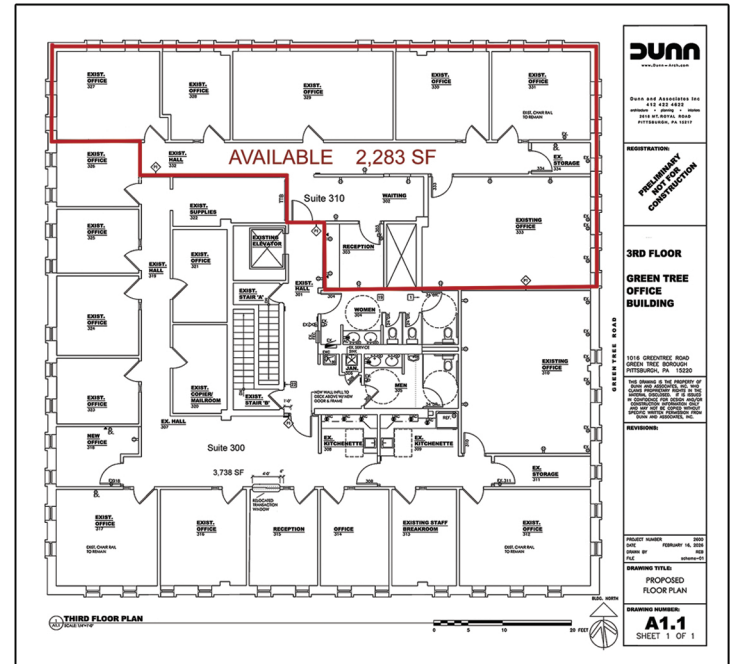

AVAILABLE FOR LEASE
2,283 Square Feet - Third Floor



Highlights

- Located in Green Tree 1/2 mile from I-279
- Easily accessible - just minutes from downtown, I-79, or the airport
- Plentiful, free parking
- Attractively designed offices and generous build-out allowances
- Full-service amenities



www.unionrealestate.com
412-288-7800

Joe Hodson | Vice President - Commercial Leasing
jbhodson@unionrealestate.com

Nate Draper | Commercial Leasing
ndraper@unionrealestate.com

One Oxford Centre | 301 Grant Street | Suite 1250 | Pittsburgh, PA 15219

PROPERTY MANAGEMENT • BROKERAGE SERVICES • THIRD-PARTY MANAGEMENT • TENANT REPRESENTATION

All information is deemed reliable, but is not guaranteed and should be independently verified. The presentation of this information is submitted subject to errors, omissions, change of price or conditions prior to lease.