

NOBLE MANOR SHOPPING CENTER



2350 Noblestown Road
Pittsburgh
Allegheny County, PA 15205

Highlights

Active mixed-use neighborhood center with Dollar Tree, Anytime Fitness, Wine & Spirits & PNC Bank

Approximately one-half mile from I-279 with easy access to I-79, the airport and downtown Pittsburgh

Near major suburban office parks

Property Acreage: 5.53 acres
Total Square Footage: 46,395
Parking Spaces: 165



www.unionrealestate.com
412-288-7800

Ed Kernisky | Senior Vice President
ekernisky@unionrealestate.com

Joe Hodson | Vice President - Commercial Leasing
jbhodson@unionrealestate.com

One Oxford Centre | 301 Grant Street | Suite 1250 | Pittsburgh, PA 15219

PROPERTY MANAGEMENT • BROKERAGE SERVICES • THIRD-PARTY MANAGEMENT • TENANT REPRESENTATION

All information is deemed reliable, but is not guaranteed and should be independently verified. The presentation of this information is submitted subject to errors, omissions, change of price or conditions prior to lease.

NOBLE MANOR SHOPPING CENTER

2350 Noblestown Road, Pittsburgh

AND BALDWIN OFFICE BUILDING

2500 Baldwin Road, Pittsburgh
Allegheny County, PA

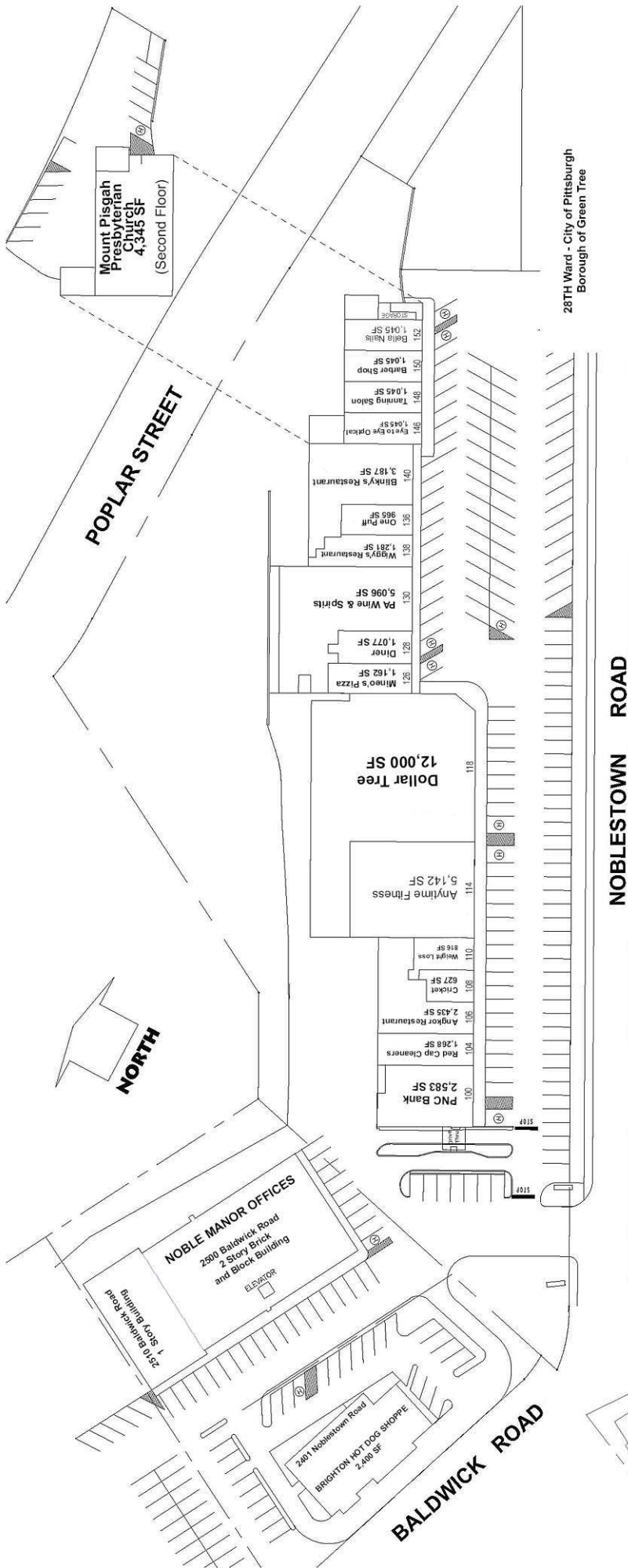

412-288-7800 | www.unionrealestate.com